

HYDRAULIC TOOLING

| Wire Size | Dies for 59973-1, 69065 | | Dies for 69067 Flag Terminals | | 59975-1, 69069 With/Self-Contained Dies | Dies for 58445-1 1752788-1 | Dies for 69082 1752786-1 | Dies for 69097 | | Dies for 69099 1752868-1 |
|-------------|-------------------------|----------|-------------------------------|------------------|---|----------------------------|--------------------------|----------------|----------|--------------------------|
| | Nest | Indenter | Nest | Indenter | | | | Nest | Indenter | |
| 8 | 48126 | 48355 | 48126• 48506• | 48355• 48505• | 59975-1 69069 | ---- | ---- | 46146 | 46145 | 69216 |
| 8 H.D. | 48128-1 | 48127-1 | 48128-1 | 48127-1 | ---- | ---- | ---- | ---- | ---- | --- |
| 6 | 48128 | 48127 | 48128• 48508• | 48127• 48507• | 59975-1 69069 | ---- | ---- | 46134 | 46133 | 69217 |
| 6 H.D. | 48129-1 | 48127-1 | 48129-1 | 48127-1 | --- | --- | --- | --- | --- | --- |
| 4 | 48129 | 48127 | 48129• 48509• | 48127• 48507• | 59975-1 69069 | --- | --- | 46135 | 46133 | 68218 |
| 4 H.D. | 48130-1 | 48127-1 | 48130-1 | 48127-1 | --- | --- | --- | --- | --- | --- |
| 2 | 48130 | 48127 | 48130• 48510• | 48127• 48507• | 59975-1 69069 | --- | --- | 46136 | 46133 | 45433 |
| 2 H.D. | 48132-1 | 48131-1 | 48132-1 | 48131-1 | --- | --- | --- | --- | --- | --- |
| 1/0 | 48132 | 48131 | 48132• 48652• | 48131• 48511• | --- | --- | --- | 46138 | 46137 | 45436 |
| 1/0 H.D. | 48133-1 | 48131-1 | 48133-1 | 48131-1 | --- | --- | --- | --- | --- | --- |
| 2/0 | 48133 | --- | 48133• 48805• | 48131• 48511• | --- | --- | --- | --- | --- | 45439 |
| 3/0 | 48134 | 48131 | 48134• 48806• | 48131• 48511• | --- | --- | --- | --- | --- | 45442 |
| 4/0 | 300430 | --- | 300430• 48807• | 48131• 48511• | --- | --- | --- | --- | --- | 45445 |
| 250-300 MCM | --- | --- | --- | --- | --- | 48816 | 69911 | --- | --- | --- |
| 300-350 MCM | --- | --- | --- | --- | --- | 48817 | 69912 | --- | --- | --- |
| 400 MCM | --- | --- | --- | --- | --- | 48818 | 69913 | --- | --- | --- |
| 500-600 MCM | --- | --- | --- | --- | --- | 48819 | 69914 | --- | --- | --- |

SOLISTRAND* Terminals and Splices
(Refer to pages 3, 4, and 5 for application tooling and accessories.)

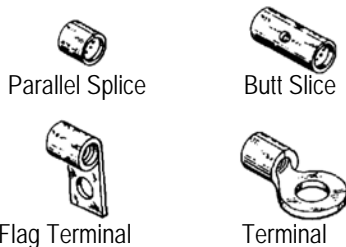

Pressure Type Wire Connector Chart (Use Type "W" Tooling)

| WIRE SIZE RANGE | UL 424C LISTED | SP LR 7189 CERTIFIED |
|----------------------------------|-------------------------|------------------------------|
| 22-16 Solid or Stranded | 22-16 Solid or Stranded | 22-16 Solid or Stranded |
| 16-14 Solid or Stranded | 16-14 Solid or Stranded | 16-14 Solid or Stranded |
| 12-10 Solid or Stranded | 12-10 Stranded | 12-10 Solid or Stranded |
| 8 Thru 600 MCM Solid or Stranded | 8 Thru 600 MCM Stranded | 8 Thru 4/0 Solid or Stranded |

NOTE: 22-16 terminals and splices are stamped 22-18 in accordance with MIL-T-7928.

| WIRE SIZE | HAND TOOLS †Long Handle ‡Heavy Head | PNEUMATIC | | | | TAPE | |
|---------------------|---|----------------------|---------------------------|--------------------|---------------------------|---|----------------------------|
| | | Heads for 626 | Heads for 69015 | Jaws for 68068-[] | Dies for 69710-1 | Dies for 69875 • Reversed •• Standard | Dies for 68250-1 |
| 26-22 | 69363† | --- | --- | --- | --- | 68108-1 | --- |
| 22-18 | --- | 314516-1 679301-1 | --- | --- | --- | --- | --- |
| 22-16 | 49935† | 314516-1 679301-1 | --- | --- | 47812 | 68240-1• 68096-1 •• | --- |
| 16-14 | 49935† | 314517-1 679301-1 | --- | --- | 47813 | 68241-1• 68097-1 •• | --- |
| 14-12 | 49592† | 314518-1 679301-1 | --- | --- | --- | 90566-1 | --- |
| 12-10 16-14 H.D. | 49935† | 679301-1 | --- | --- | 47814 (Str. Wire Only) | 68242-1• 68338-1 •• | --- |
| | 49965† (Flag Only) | | | | | | |
| 8 | 69339‡ (Str. Wire) | 1338757-1 | 49956 | 68135 | --- | 68243-1 (Single Indent) | 68312-1 (Single Indent) |
| | 69355‡ | | 48412 (Flag Terminals) | | | | |
| 6 | 59083‡ (No Ratchet) | 1338758-1 | 48172 | 68136 | --- | --- | 68313-1 (Single Indent) |
| | | | 48413 (Flag Terminals) | | | | |
| 4 | --- | --- | 48173 | --- | --- | --- | --- |
| 2 | --- | --- | 48174 | --- | --- | --- | --- |
| | | | 48415 (Flag Terminals) | | | | |
| 1/0 | --- | --- | 48183 | --- | --- | --- | --- |

AMPOWER* Terminals and Splices



Terminal

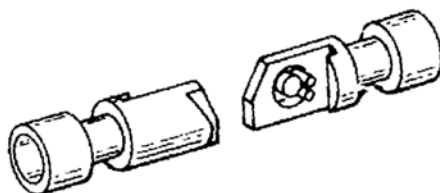

Quick Disconnect



Parallel Splice



Butt Slice

Pressure Type Wire Connector Chart (Use Type "C" Tooling)

| WIRE SIZE RANGE | UL 424C LISTED | CSA LR 7189 CERTIFIED |
|-----------------|-----------------------------|-----------------------------|
| 6 thru 1000 MCM | 6 thru 1000 MCM Stranded | 6 thru 1000 MCM Stranded |

| WIRE SIZE | HYDRAULIC TOOLING (Use Power Unit 69120-[] or 314979-1 †Quick Disconnect Terminals Only) | | | | |
|-----------|---|-----------------------------|---------------------------|-------------------------------|------------------|
| | Dies for 69099 1752868-1 | Dies for 69082 1752786-1 | Dies for 69065 59973-1 | Dies for 58445-1 1752788-1 | Dies for 68073-2 |
| 6 | 69133-1 | --- | --- | --- | --- |
| 4 | 69134-2 | --- | --- | --- | --- |
| 2 | 46765-3 | --- | 46321-3 | --- | --- |
| 1/0 | 46766-2 | --- | 46322-2 | --- | --- |
| | 68361-1 †(with locator) | | | | |
| 2/0 | 46767-2 | --- | 46323-2 | --- | --- |
| | 68253-1 †(with locator) | | | | |
| 3/0 | 46749-2 | --- | 46324-2 | --- | --- |
| | 59867-1 †(with locator) | | | | |
| 4/0 | 46750-2 | --- | 46325-2 | --- | --- |
| | 68304-1 †(with locator) | | | | |
| 250 MCM | 46751-2 68203-1† | --- | --- | 46326-2 | --- |
| 300 MCM | 46752-2 | --- | --- | --- | --- |
| 400 MCM | 46753-2 | 69653 68204-1† | --- | --- | --- |
| 500 MCM | --- | 46755-2 68206-1† | --- | --- | --- |
| 600 MCM | --- | 46756-2 | --- | --- | --- |
| 600 H.D. | --- | 59870-1 | --- | --- | --- |
| 700 MCM | --- | 46757-2 | --- | --- | --- |
| 800 MCM | --- | 46758-2 | --- | --- | --- |
| 900 MCM | --- | 46759-2 | --- | --- | --- |
| 1000 MCM | --- | 46760-2 | --- | --- | --- |
| 1250 MCM | --- | --- | --- | --- | 68114-1 |
| 1500 MCM | --- | --- | --- | --- | 68282-1 |

TOOLING AND ACCESSORIES

Hydraulic Crimping Heads

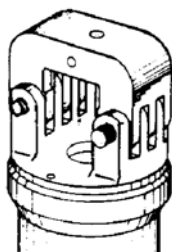

58445-1
1752788-1

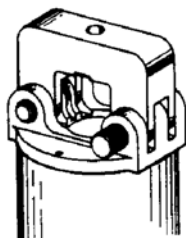

69065



69097



69082
1752786-1

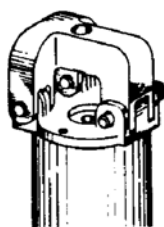

69067

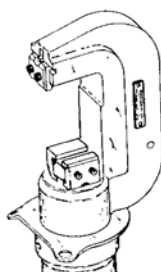

68073-2



69069



69099
1752868-1

Hand Tools

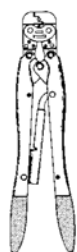

Long and
Short Handle



69710-1



Heavy Head

TOOLING AND ACCESSORIES

Hydraulic

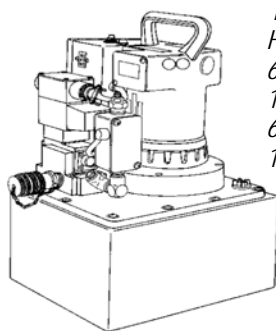

DYNA-CRIMP*
Hydraulic Power Units
69120-1 (115 VAC - 60 Hz)
1804700-1 (115 VAC - 60 Hz)
69120-2 (230 VAC - 60 Hz)
1804700-2 (230 VAC - 60 Hz)

Handle Control W/Hose and
Cord 59907-[] and 1901775-[]

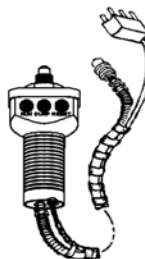

Foot Control
68284-1

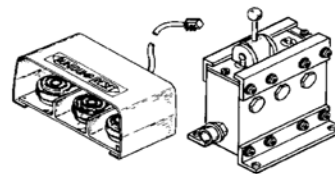

Hose Assy W/Crimping
Head Coupling

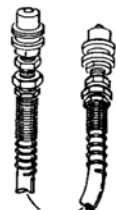

3-Way
Multidirectional
Valve

59220 (No Safety Sw)
59220-2 (W/Safety Sw)

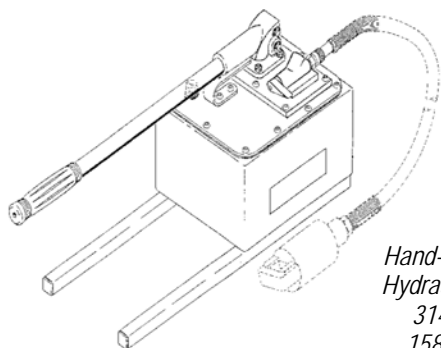

Hand-Operated
Hydraulic Pump
314979-1
1583661-1

59909-[]
1583662-[]

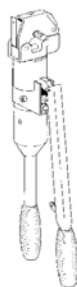

Hand Tool
59975-1



Hand Tool
59973-1

Tape Machines

AMP-TAPETRONIC*
Machine
68250-1

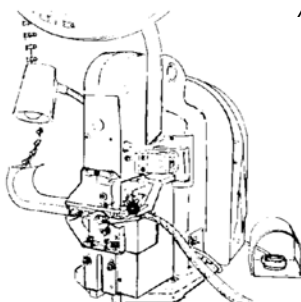

AMP-TAPETRONIC*
Machine
69875

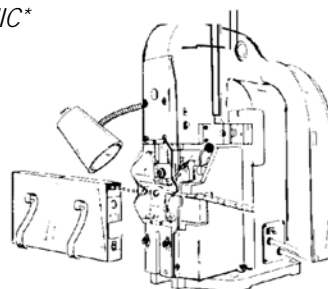

Pneumatic

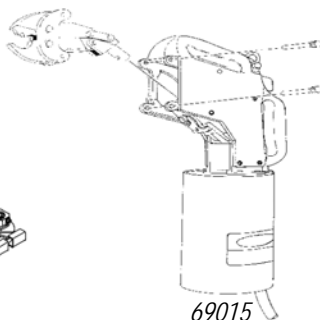
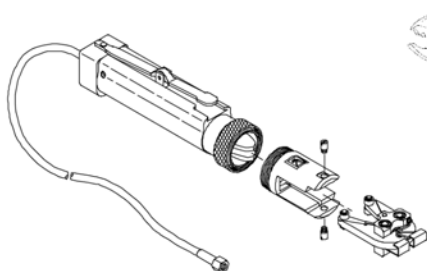

69015

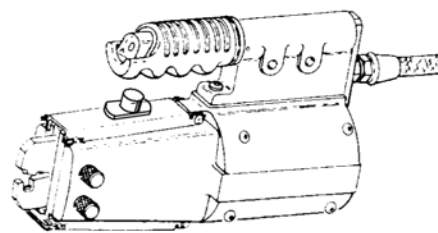

68068

REVISION SUMMARY:

Since the previous version of this document, the following changes were made:

- Changed part number reference on Page 1.

Mouser Electronics

Authorized Distributor

Click to View Pricing, Inventory, Delivery & Lifecycle Information:

[TE Connectivity:](#)

[45436](#) [47813](#)