

REV.	DATE	DESCRIPTION
A	01/25/04	UPDATE DRAWING FORMAT

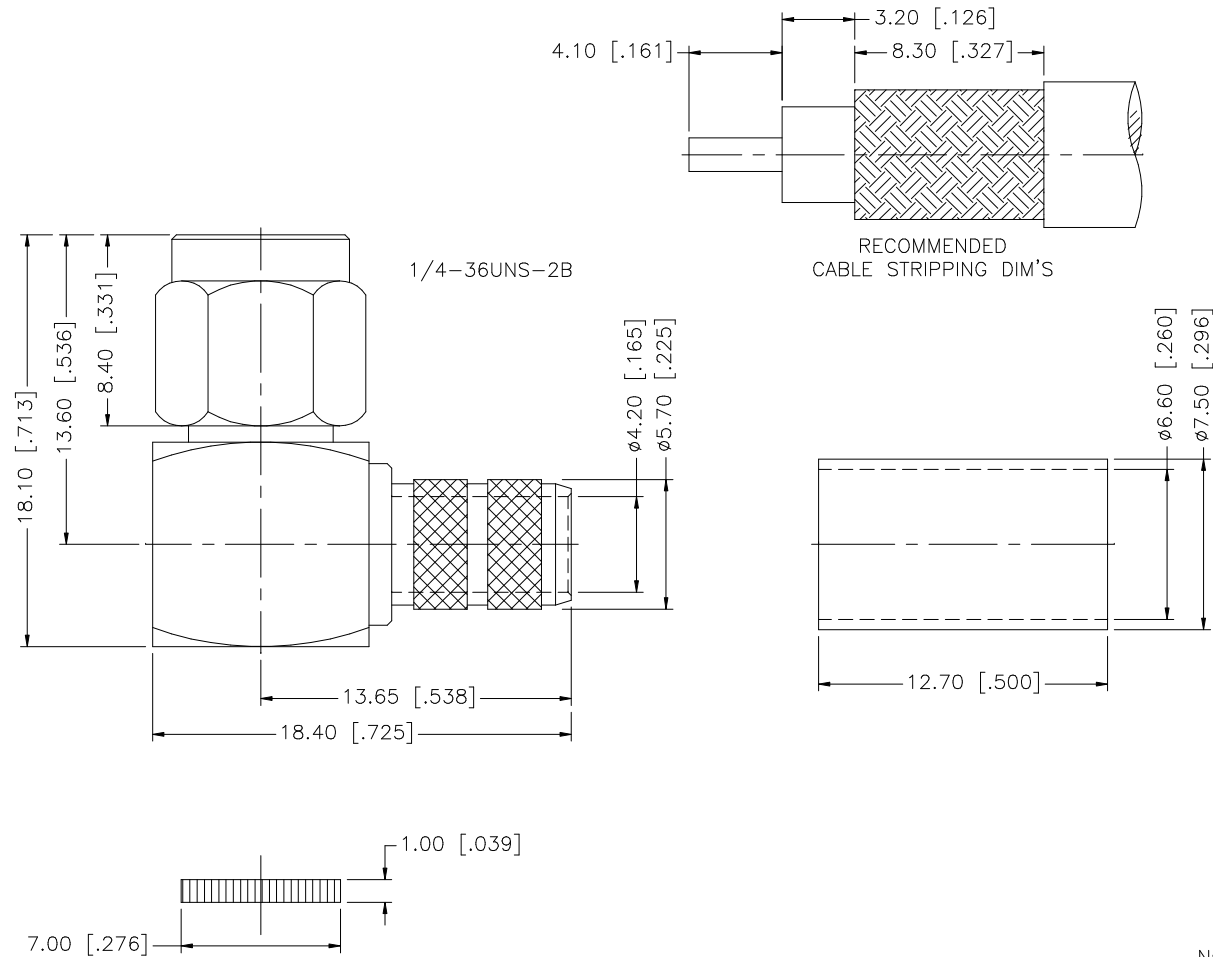

NOTE:
1. CRIMPED FERRULE
HEX CRIMP SIZE .255"

					<div>UNLESS OTHERWISE SPECIFIED DIMENSIONS ARE IN MILLIMETERS. DIMENSIONS IN [] ARE IN INCHES AND FOR CUSTOMER REFERENCE ONLY.</div> <div>UNLESS OTHERWISE SPECIFIED TOLERANCES FOR MILLIMETERS ARE: 0.5 – 8mm ± 0.20mm 8 – 30mm ± 0.40mm 30 – 120mm ± 0.50mm</div> <div>UNLESS OTHERWISE SPECIFIED TOLERANCES FOR INCHES ARE: .020 – .315 = ± 0.007" .315 – 1.180 = ± 0.015" 1.180 – 4.724 = ± 0.020"</div> <div>DO NOT SCALE DRAWING</div>	APPROVALS		DATE		<div>Amphenol Connex</div>								
8						DRAWN	G.R.S.	01/25/04										
7						CHECKED												
6										PART DESCRIPTION								
5	FERRULE	COPPER	GOLD	1						SMA R/A CRIMP PLUG (FOR RG-8X, LMR-240)								
4	COVER	BRASS	GOLD	1														
3	CONTACT PIN	BRASS	GOLD	1						PART NO.								
2	INSULATOR	TEFLON	NATURAL	1						132239								
1	BODY	BRASS	GOLD	1					CAD FILE		DWG. NO.		132239.DWG		REV. A	SIZE A	SCALE NA	
DESCRIPTION					MATERIAL	FINISH	QTY	C:/132/132239.DWG										

Mouser Electronics

Authorized Distributor

Click to View Pricing, Inventory, Delivery & Lifecycle Information:

[Amphenol:](#)

[132239](#)